



LEGEND

- Construction & Infrastructure Hall (E)
- Manufacturing Hall (M)
- Energy Hall (C)
- Mining Hall (MI)
- Agriculture Hall (A)
- Chemicals Hall (CH)
- Logistics Hall (L)
- Finance Hall (F)
- FH Fire Hose

FLOOR PLAN

Hibarri International
 Commodity Summit 2025
 Venue: CTICC 1 - Level 0 - Halls 1, 2, 3, 4,
 Clivia Conservatory, Jasminium and Strelitzia Resaurants
 Show Dates: 14-17 July 2025

AE adele@scandisplay.co.za
 DESIGN winette@scandisplay.co.za



© 2024 Scan Display Solutions (Pty) Limited. All rights reserved. This document, including all designs, concepts, and proposals contained herein, is the intellectual property of Scan Display Solutions (Pty) Limited. Unauthorized reproduction, reverse engineering, distribution, or use of this material, in whole or in part, is strictly prohibited without the prior written consent of Scan Display Solutions (Pty) Limited. Colours and graphics are depicted as close as possible but may differ from the actual product. Unless otherwise specified, all dimension are in mm (Millimeters)

DWG NO: 182/rev2
 2025-02-25



- LEVEL 0**
- 1. Main Entrance Exterior
 - 2. Auditorium 2
 - 3. North Terrace
 - 4. Coffee Shop
 - 5. Main Registration
 - 6. Registration Foyers Exhibitors
 - 7. Construction & Infrastructure Hall
 - 8. Manufacturing Hall
 - 9. Logistics Hall
 - 10. Foyer (Main)
 - 11. Energy Hall
 - 12. Finance Hall
 - 13. Mining Hall
 - 14. Innovators Stage
 - 15. Speakers Lounge
 - 16. Agriculture Hall
 - 17. Meeting Booths
 - 18. Chemicals Hall
 - 19. Textiles
 - 20. Recycling
 - 21. Staff Dedicated Restaurants
 - 22. Media Box
 - 23. Paparazzi
 - 24. Photo Wall
 - 25. Marshalling Yard
 - E1. Registration (Exhibitors) Entrance
 - E2. Main Entrance 1
 - E3. Main Entrance 2
 - E4. Manufacturing Hall Entrance
 - E5. Construction & Infrastructure Hall Entrance
 - E6. Logistics Hall Entrance
 - E7. Energy Hall Entrance
 - E8. Finance Hall Entrance
 - E9. Mining Hall Entrance
 - E10. Tech Hall Entrance
 - E11. Agriculture Hall Entrance
 - E12. Exit

SITE PLAN LEVEL 0

Hibarri International
Commodity Summit 2025
Venue: CTICC 1 - Level 0 - Halls 1, 2, 3, 4,
Clivia Conservatory, Jasminium and Strelitzia Resaurants
Show Dates: 14-17 July 2025

AE adele@scandisplay.co.za
DESIGN winette@scandisplay.co.za

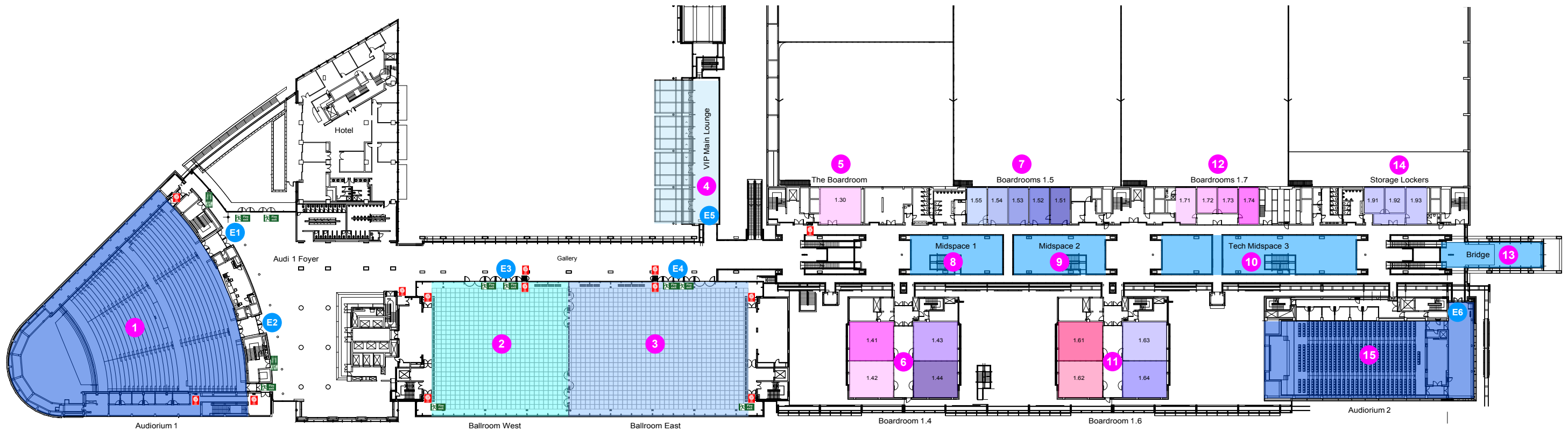

- LEVEL 1**
- | | | |
|---------------------------------|----------------------------------|------------------------------|
| 1. Auditorium 1 | 8. Midspace 1 | 15. Auditorium 2 |
| 2. Ballroom West | 9. Midspace 2 | E1. Auditorium 1 Entrance A |
| 3. Ballroom East | 10. Tech Midspace 3 | E2. Auditorium 1 Entrance B |
| 4. VIP Main Lounge | 11. Boardroom 1.6 (4x available) | E3. Ballroom West Entrance |
| 5. Boardroom 1.3 | 12. Boardroom 1.7 (4x available) | E4. Ballroom East Entrance |
| 6. Boardroom 1.4 (4x available) | 13. Bridge | E5. VIP Main Lounge Entrance |
| 7. Boardroom 1.5 (5x available) | 14. Storage Lockers | E6. Auditorium 2 Entrance |

SITE PLAN LEVEL 1

Hibarri International
Commodity Summit 2025
Venue: CTICC 1 - Level 1
Show Dates: 14-17 July 2025

AE adele@scandisplay.co.za
DESIGN winette@scandisplay.co.za

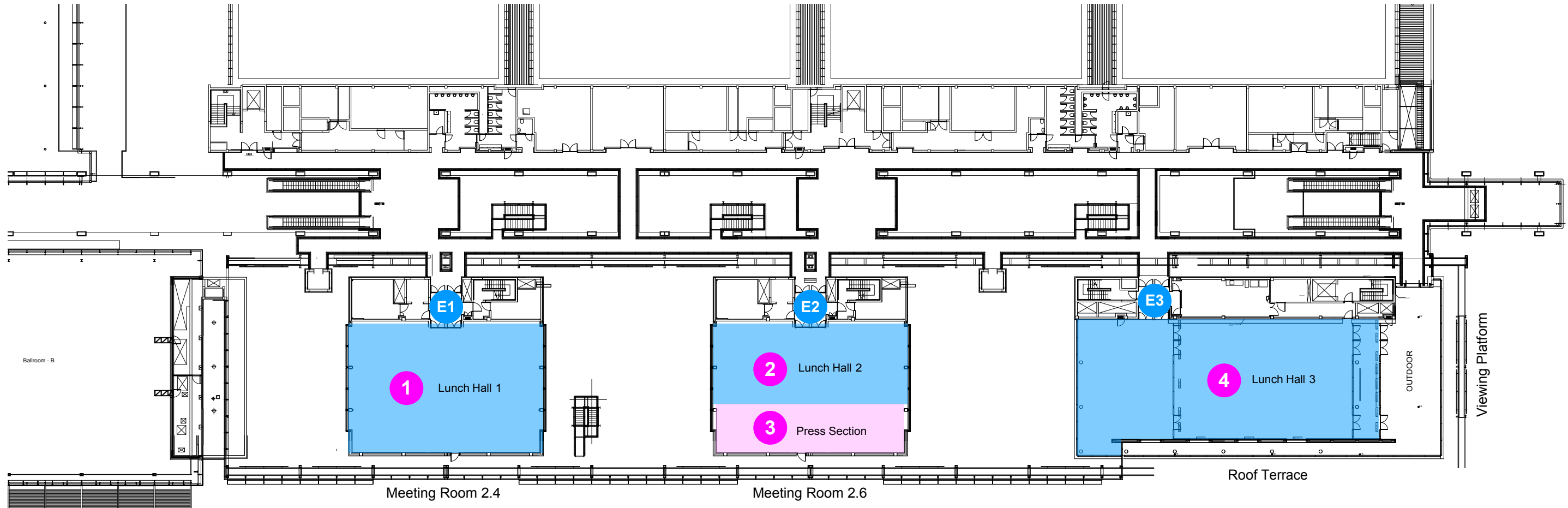

- LEVEL 2**
- 1. Lunch Hall 1
 - 2. Lunch Hall 2
 - 3. Press Section
 - 4. Lunch Hall 3
 - E1. Lunch Hall 1 Entrance
 - E2. Lunch Hall 2 Entrance
 - E3. Lunch Hall 3 Entrance

SITE PLAN LEVEL 2

Hibarri International
Commodity Summit 2025
Venue: CTICC 1 - Level 2
Show Dates: 14-17 July 2025

AE adele@scandisplay.co.za
DESIGN winette@scandisplay.co.za

DWG NO: 182/rev2
2025-02-25